

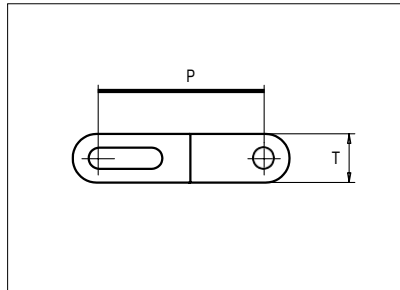

Plastic Modular Belt

Series **uni Flex L-ASB** Type **47% Open (Radius 2.2)**

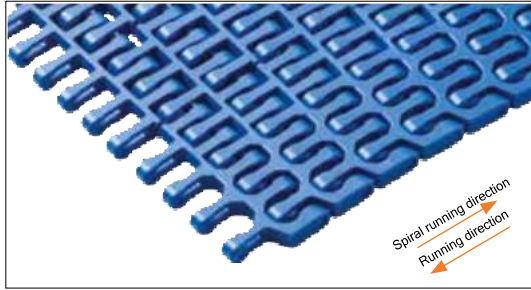

Sideflexing belt
 Nominal pitch: 50.8 mm (2.00 in)
 Surface type: Flat
 Surface opening: 47%
 Backflex radius: 100.0 mm (3.94 in)
 Pin diameter: 6.0 mm (0.24 in)
 Min. inside radius: 2.2 x belt width

STANDARD

Belt material & color	POM-D B W	PP B W	mm	in
			P (Nominal)	50.8 / 2.00
Pin and lock material & color	PA6.6 B		T	15.0 / 0.59

Non standard material and color: See uni Material and Color Overview.
 Alternative pin and lock systems and materials: Contact Customer Service.

SIDE FLEXING

Belt width		Permissible tensile force (Belt/pin material)								Belt weight (Belt/pin material)				*Min. No. drive sprocket per shaft	Number of wear strips (Min. No.)	
		POM-D/PA6.6				PP/PA6.6				POM-D/PA6.6		PP/PA6.6			**Carry (pcs)	**Return (pcs)
		Straight sections		Curve sections		Straight sections		Curve sections		kg/m	lb/ft	kg/m	lb/ft			
mm	in	N	lbf	N	lbf	N	lbf	N	lbf	kg/m	lb/ft	kg/m	lb/ft			
250	9.8	10000	2248	2440	549	5000	1124	1440	324	2.5	1.65	1.5	1.01	2	2	2
326	12.8	13040	2931	2440	549	6520	1466	1440	324	3.2	2.15	2.0	1.31	3	3	2
403	15.9	16120	3624	3110	699	8060	1812	1960	441	3.9	2.65	2.4	1.63	3	3	2
479	18.9	19160	4307	3110	699	9580	2154	1960	441	4.7	3.15	2.9	1.93	5	4	2
555	21.9	22200	4991	3110	699	11100	2495	1960	441	5.4	3.66	3.3	2.24	5	4	2
631	24.8	25240	5674	3110	699	12620	2837	1960	441	6.2	4.16	3.8	2.54	5	5	3
708	27.9	28320	6366	3110	699	14160	3183	1960	441	6.9	4.66	4.2	2.85	5	5	3
784	30.9	31360	7050	3110	699	15680	3525	1960	441	7.7	5.16	4.7	3.16	7	6	3
860	33.9	34400	7733	3110	699	17200	3867	1960	441	8.4	5.66	5.2	3.47	7	6	3
936	36.9	37440	8417	3110	699	18720	4208	1960	441	9.2	6.16	5.6	3.77	7	7	4
1013	39.9	40520	9109	3110	699	20260	4554	1960	441	9.9	6.67	6.1	4.08	7	7	4
1089	42.9	43560	9792	3110	699	21780	4896	1960	441	10.7	7.17	6.5	4.39	9	8	4

PITCH 50.8 MM/2.00 IN

Additional standard belt widths are available in steps of 76.2 mm (3.00 in). Additional non-standard belt widths are available in steps of 25.4 mm (1.00 in).

1699	66.9	67960	15277	3110	699	33980	7639	1960	441	16.7	11.19	10.2	6.85	13	12	6
------	------	-------	-------	------	-----	-------	------	------	-----	------	-------	------	------	----	----	---

Additional standard belt widths are available in steps of 76.2 mm (3.00 in). Additional non-standard belt widths are available in steps of 25.4 mm (1.00 in).

1927	75.9	77080	17328	3110	699	38540	8664	1960	441	18.9	12.69	11.6	7.77	13	13	7
------	------	-------	-------	------	-----	-------	------	------	-----	------	-------	------	------	----	----	---

General belt tolerance is +0/-0.4% at 23°C/73°F. For exact belt width contact Customer Service. Non standard belt width on request.

*Max. Load per Drive Sprocket. Belt material: POM-D 2500 N (562 lbf), PP 1200 N (270 lbf).

**Max. Spacing between wear strips, Carry: 152.0 mm (6.00 in); Return: 304.0 mm (12.00 in).

= Single Link



Distribué par :



Accessories

Rubber Top



Type	Belt material & color	Rubber material, hardness & color	X	
			mm	in
Curved	PP B	TPE-S Shore A60 K	3.0	0.12

uni Flex L-ASB Rubber Top Radius 2.2: Indent min. 71.0 mm (2.80 in) and Increment 25.4 mm (1.00).

Accessories

Side Guard Closed

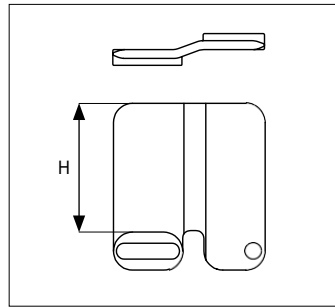
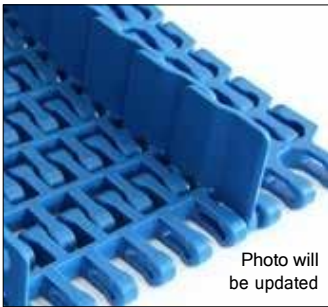

Side Guard Open

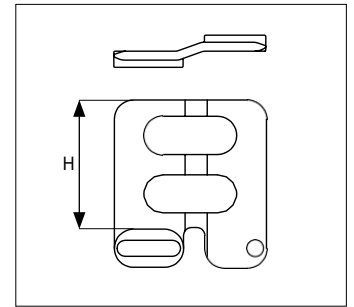
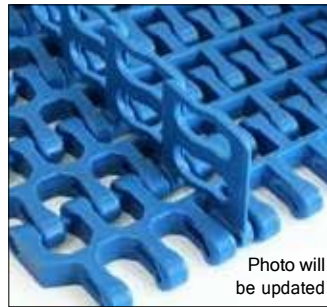

Side Guard Outside Closed

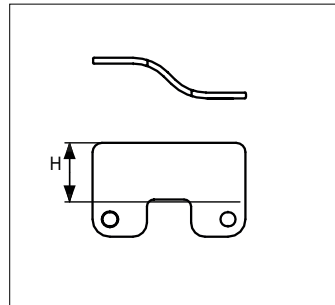
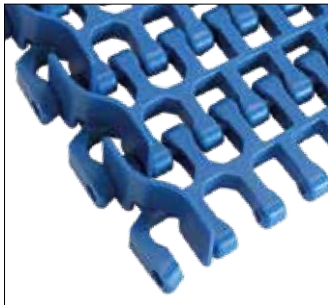

Type	Material & color	H	
		mm	in
Side Guard Closed	POM-D B	10.0	0.39
		25.4	1.00
		50.0	1.97
Side Guard Open		50.0	1.97
Side Guard Outside Closed		25.4	1.00

Min. indent for Side Guard Closed and Side Guard Open: 55.0 mm (2.17 in) and Increment 25.4 mm (1.00 in).

Min/max indent for Side Guard Outside Closed: 10.0 mm (0.39 in).

Non Standard material and color: See uni Material and Color Overview.

Accessories

Bottom Tab

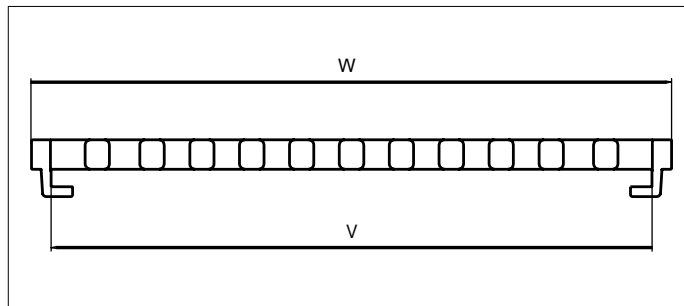
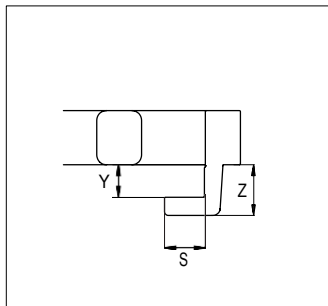

Type	Bottom Tab material and colors	S		V		W		Y		Z	
		mm	in	mm	in	mm	in	mm	in	mm	in
Hold Down Edge	POM-D B W	11.0	0.43	306.5	12.07	325.9	12.83	9.0	0.35	14.0	0.55
	PP B W										

Non Standard material and color: See uni Material and Color Overview.

Accessories

AmFlight

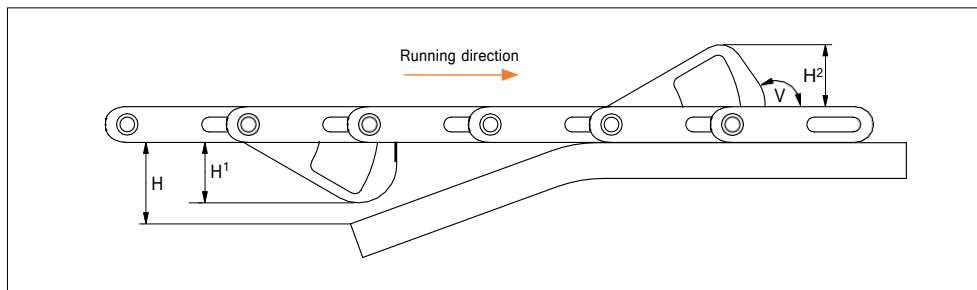

Type	Material & color	H	H'		H ²		V
			mm	in	mm	in	
Push	PE W	H > H ¹	25.4	1.00	26.0	1.02	125

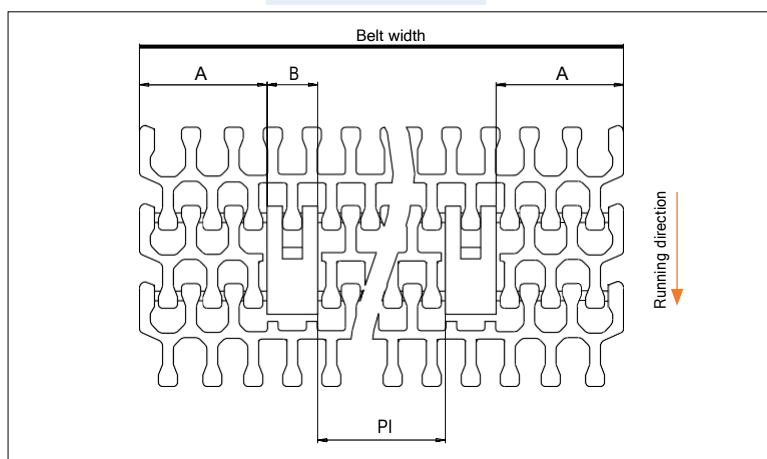

	mm	in
A min	83.0	3.27
B	33.0	1.30
PI min	68.5	2.70

Increment: 25.4 mm (1.00 in).

Distribué par :



Design Guidelines

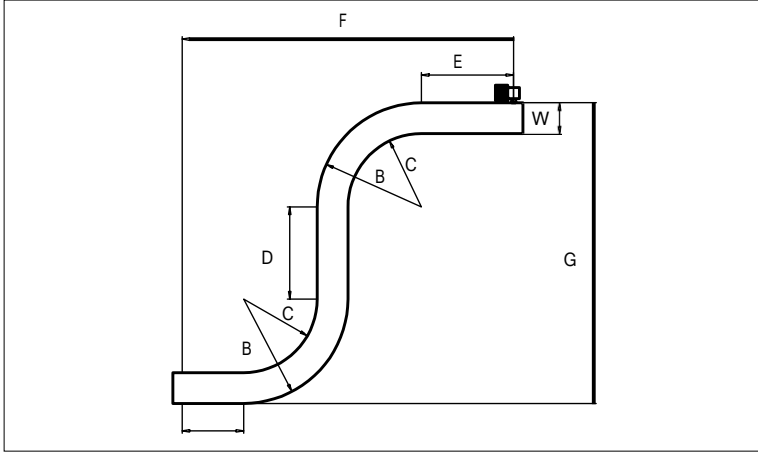

uni Flex L-ASB R2.2	
A	min. 1.5 x W
B	min. 3.2 x W
C	min. 2.2 x W
D	min. 2.0 x W
E	min. 2.0 x W
F	min. 8.9 x W
G	min. 8.4 x W

For min. conveyor dimensions please refer to sketch and diagram.

Sprocket

No. of teeth	Pilot Bore	Bore size							Overall diameter		Pitch diameter		Hub diameter		Dimension A		Dimension B		Single row/Two way	Machined PA6 N
		in	1.00	1.18	1.25	1.50	1.57	2.50												
		mm	25.4	30.0	31.8	38.1	40.0	63.5	mm	in	mm	in	mm	in	mm	in	mm	in		
Z08	✓		●	●				134.6	5.30	131.5	5.18	107.6	4.23	54.4	2.14	74.9	2.95	✓	✓	
Z10	✓		●	●	●			168.3	6.63	164.0	6.46	141.3	5.56	71.4	2.81	90.8	3.57	✓	✓	
Z12	✓		●	●	●	●		203.5	8.01	196.5	7.74	176.5	6.94	88.2	3.47	106.8	4.20	✓	✓	
Z15	✓		●	●	●	●	■	253.4	9.98	245.4	9.66	226.4	8.91	113.2	4.46	131.0	5.16	✓	✓	

■ Machined sprocket

● Machined sprocket

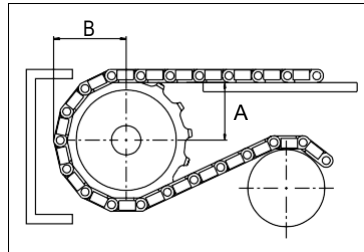

Non standard material and color: See uni Material and Color Overview.

Other sprocket sizes are available upon request
 Two-part sprocket are available upon request
 Other bore sizes are available upon request
 uni Retainer Rings: See uni Retainer Ring data sheet
 Width of tooth = 15.0 mm (0.59 in)
 Width of sprocket = 30.0 mm (1.18 in)

Max. load per sprocket shown does not take bore size into account.
 Please also ensure that sufficient size shaft is chosen for corresponding load.

For correct sprocket position: See uni Assembly Instructions for uni Flex L-ASB.
 For more detailed sprocket information, contact Customer Service.