

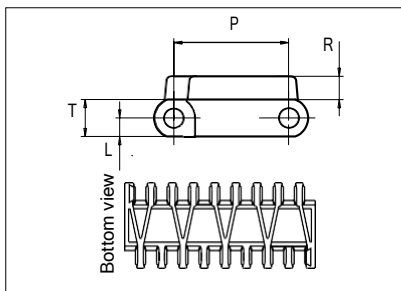

Plastic Modular Belt

Serie **uni OPB 4V** Type **23% Rib**



Straight running belt
 Nominal pitch: 50.0 mm (1.97 in)
 Surface type: Rib Top
 Surface opening: 23%
 Backflex radius: 300.0 mm (11.80 in)
 Pin diameter: 8.0 mm (1.97 in)

*uni-chains recommends this travel direction. However, travel in both directions is possible.

Note: uni OPB 36% 4V are listed in the USDA "Accepted Meat and Poultry Equipment" publication as accepted food contact.

| Belt material & color | PP-HW LB | PP G | | | mm | in | | | mm | in |
|-----------------------|-------------------------------|-----------------|-------------|---|-------------|------|------|------|------|----|
| | Pin and lock material & color | PP-HW LB | PP W | T | P (Nominal) | 16.0 | 0.63 | 50.0 | 1.97 | L |
| | | | | | 8.0 | 0.31 | 10.0 | 0.39 | | |

Non standard material and color: See uni Material and Color Overview.

Alternative pin and lock materials: Trilock: PP-HW **LB** Endlock: PP **W G B** PE **W B** Lockpin: PP **W** PE **W** PA6.6 **N B** PBT **LG**
 Pin: PP **W** PE **W** PBT **LG** SS304 and SS316

| Belt width | | Permissible tensile force (Belt/pin material) | | | | Belt weight (Belt/pin material) | | | | *Min. No. drive sprocket per shaft | Number of wear strips (Min. No.) | |
|------------|------|---|------|----------|------|---------------------------------|-------|----------|-------|------------------------------------|----------------------------------|----------------|
| | | PP-HW/PP-HW | | PP/PP-HW | | PP-HW/PP-HW | | PP/PP-HW | | | **Carry (pcs) | **Return (pcs) |
| mm | in | N | lbf | N | lbf | kg/m | lb/ft | kg/m | lb/ft | | | |
| 151 | 5.9 | 1661 | 373 | 1661 | 373 | 1.0 | 0.69 | 1.0 | 0.69 | 2 | 2 | 2 |
| 302 | 11.9 | 3322 | 747 | 3322 | 747 | 2.1 | 1.38 | 2.1 | 1.38 | 3 | 3 | 2 |
| 453 | 17.8 | 4983 | 1120 | 4983 | 1120 | 3.1 | 2.07 | 3.1 | 2.07 | 4 | 4 | 2 |
| 604 | 23.8 | 6644 | 1494 | 6644 | 1494 | 4.1 | 2.76 | 4.1 | 2.76 | 5 | 5 | 3 |
| 755 | 29.7 | 8305 | 1867 | 8305 | 1867 | 5.1 | 3.45 | 5.1 | 3.45 | 6 | 6 | 3 |
| 906 | 35.7 | 9966 | 2240 | 9966 | 2240 | 6.2 | 4.14 | 6.2 | 4.14 | 7 | 7 | 4 |
| 1057 | 41.6 | 11627 | 2614 | 11627 | 2614 | 7.2 | 4.83 | 7.2 | 4.83 | 8 | 8 | 4 |
| 1208 | 47.6 | 13288 | 2987 | 13288 | 2987 | 8.2 | 5.52 | 8.2 | 5.52 | 9 | 9 | 5 |
| 1359 | 53.5 | 14949 | 3361 | 14949 | 3361 | 9.2 | 6.21 | 9.2 | 6.21 | 10 | 10 | 5 |
| 1510 | 59.4 | 16610 | 3734 | 16610 | 3734 | 10.3 | 6.90 | 10.3 | 6.90 | 11 | 11 | 6 |
| 1661 | 65.4 | 18271 | 4107 | 18271 | 4107 | 11.3 | 7.59 | 11.3 | 7.59 | 12 | 12 | 6 |
| 1812 | 71.3 | 19932 | 4481 | 19932 | 4481 | 12.3 | 8.28 | 12.3 | 8.28 | 13 | 13 | 7 |

Additional standard belt widths are available in steps of 151.0 mm (5.94 in). Additional non-standard belt widths are available in steps of 33.6 mm (1.32 in).

| | | | | | | | | | | | | |
|------|-------|-------|------|-------|------|------|-------|------|-------|----|----|---|
| 2567 | 101.1 | 28237 | 6348 | 28237 | 6348 | 17.5 | 11.73 | 17.5 | 11.73 | 18 | 18 | 9 |
|------|-------|-------|------|-------|------|------|-------|------|-------|----|----|---|

Additional standard belt widths are available in steps of 151.0 mm (5.94 in). Additional non-standard belt widths are available in steps of 33.6 mm (1.32 in).

| | | | | | | | | | | | | |
|------|-------|-------|------|-------|------|------|-------|------|-------|----|----|----|
| 2869 | 113.0 | 31559 | 7094 | 31559 | 7094 | 19.5 | 13.11 | 19.5 | 13.11 | 20 | 20 | 10 |
|------|-------|-------|------|-------|------|------|-------|------|-------|----|----|----|

General belt tolerance is +0/-0.4% at 23°C/73°F and 50% RH. For exact belt width contact Customer Service. Non standard belt width on request.

*Max. Load per Drive Sprocket. Belt material: POM 2500 N (562 lbf), PP 1200 N (270 lbf), PE 500 N (270 lbf)

**Max. Spacing between wear strips, Carry: 152.0 mm (6.00 in); Return: 304.0 mm (12.00 in).

= Single Link



Distribué par :



COPIMEC Sarl au Capital de 8.000.000,00 dh / Adresse: N°237, Rue Oued Ziz - Quartier Industriel - Teldi - AGADIR - MAROC
 TEL : +212 5 28 84 75 61 - +212 5 28 84 75 62 - FAX : +212 5 28 84 73 00 E-mail: contact@copimec.com Web: www.copimec.com

STANDARD

STRAIGHT RUNNING

PITCH 50.0 MM/1.97 IN

Accessories

Finger Plates

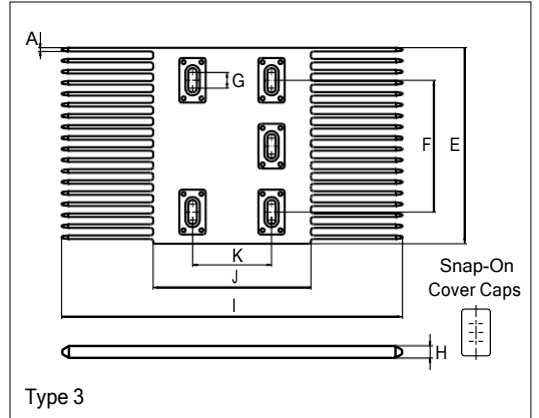
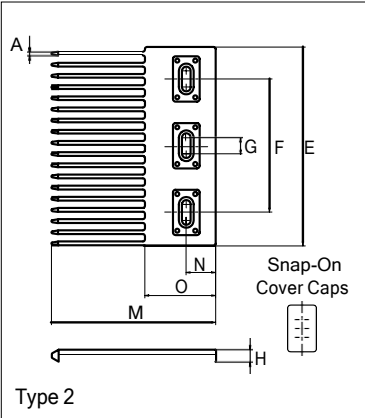
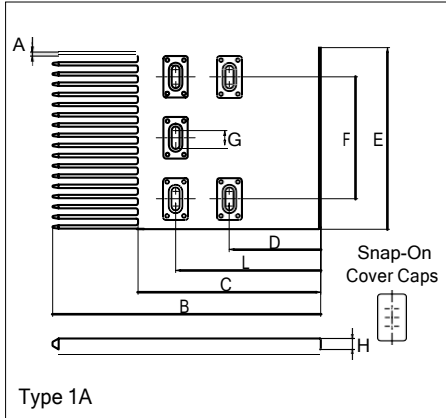

| Type | Material & color | A | | B | | C | | D | | E | | F | |
|--------------|------------------|-----|------|-------|------|-------|------|------|------|-------|------|-------|------|
| | | mm | in | mm | in | mm | in | mm | in | mm | in | mm | in |
| Single Sided | POM-DI G | 2.8 | 0.11 | 220.0 | 8.66 | 150.0 | 5.91 | 75.0 | 2.95 | 149.0 | 5.87 | 100.0 | 3.94 |
| Double Sided | | | | | | | | | | | | | |

| G | | H | | I | | J | | K | | L | | M | | N | | O | |
|------|------|-----|------|-------|-------|-------|------|------|------|-------|------|-------|------|------|------|------|------|
| mm | in | mm | in | mm | in | mm | in | mm | in | mm | in | mm | in | mm | in | mm | in |
| 12.0 | 0.47 | 9.0 | 0.35 | 259.0 | 10.20 | 120.0 | 4.72 | 60.0 | 2.36 | 119.0 | 4.69 | 123.0 | 4.84 | 22.0 | 0.87 | 53.0 | 2.09 |

All uni-chains belt systems are available in a raised rib version that can be supplied with matching finger plates, also called combs.

The finger plates are supplied with cover caps which can be attached when the finger plate has been installed. The cover caps can be removed by using a screwdriver that can be inserted between the cover and finger plate. In order to adjust to belt width variations caused by temperature fluctuations, a slider facilitates the sideways movement of the finger plates.

Non Standard material and color: See uni Material and Color Overview.

Sprocket

| No of teeth | Bore size | | | | | | | | | | | | | Overall diameter | | Pitch-diameter | | Hub-diameter | | Dimension A | | Dimension B | | Single row/Two way | Double row/Two way | Molded PA6 LG | Machined PA6 N |
|-------------|------------|------|------|------|------|------|------|------|------|------|------|------|-------|------------------|-------|----------------|-----|--------------|-------|-------------|-------|-------------|---|--------------------|--------------------|---------------|----------------|
| | Pilot Bore | in | 0.75 | 0.78 | 0.98 | 1.00 | 1.18 | 1.25 | 1.50 | 1.57 | 2.36 | 2.50 | 3.54 | | | | | | | | | | | | | | |
| | mm | 19.1 | 20.0 | 25.0 | 25.4 | 30.0 | 31.8 | 38.1 | 40.0 | 60.0 | 63.5 | 90.0 | mm | in | mm | in | mm | in | mm | in | | | | | | | |
| Z06 | x | | | | ● | ● | ● | ■ | ■ | | | | 94.5 | 3.72 | 100.3 | 3.95 | 65 | 2.56 | 35.5 | 1.40 | 58.6 | 2.31 | x | | x | | |
| Z08 | x | | | | ● | ● | ● | ■ | ■ | | | | 129 | 5.08 | 131.1 | 5.16 | 65 | 2.56 | 52.6 | 2.07 | 74 | 2.91 | x | | x | | |
| Z10 | x | | | | | ● | ● | ■ | ■ | | | | 160.1 | 6.30 | 162.4 | 6.39 | 65 | 2.56 | 69.2 | 2.72 | 89.7 | 3.53 | x | | x | | |
| Z12 | x | | | | | ● | ● | ■ | ■ | | | | 191.5 | 7.54 | 193.9 | 7.63 | 65 | 2.56 | 85.7 | 3.37 | 105.5 | 4.15 | x | | x | | |
| Z13 | x | | | | | ● | | ■ | ■ | | | | 207.3 | 8.16 | 209.7 | 8.26 | 72 | 2.83 | 93.8 | 3.69 | 113.4 | 4.46 | x | | x | | |
| Z13 | | | | | | | | | | | ■ | | 207.3 | 8.16 | 209.7 | 8.26 | 150 | 5.91 | 93.8 | 3.69 | 113.4 | 4.46 | x | | | x | |
| Z16 | x | | | | | ● | | ■ | ■ | | | ■ | 254.8 | 10.03 | 257.3 | 10.13 | 200 | 7.87 | 118.2 | 4.65 | 137.1 | 5.40 | x | | | x | |

■ Molded sprocket

● Molded sprocket

■ Machined sprocket

● Machined sprocket

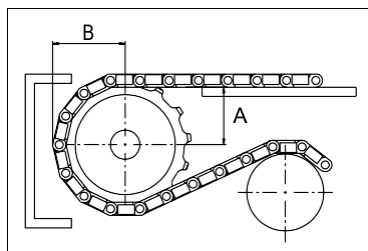

Other sprocket sizes are available upon request.

Two-part sprocket are available upon request.

Round bores are always delivered with keyway.

Other bore sizes are available upon request.

uni Retainer Rings: See uni Retainer Ring data sheet

Width of tooth = 11.0 mm (0.43 in)

Width of sprocket = 42.3 mm (1.67 in)

Max load per sprocket shown does not take bore size into account.

Please also ensure that sufficient size shaft is chosen for corresponding load.

For correct sprocket position: See uni Assembly Instructions for uni OPB.

For more detailed sprocket information. contact Customer Service.

Non standard material and color: See uni Material and Color Overview.

Ammeraal beltech - unichains - copimec

Distribué par :

